

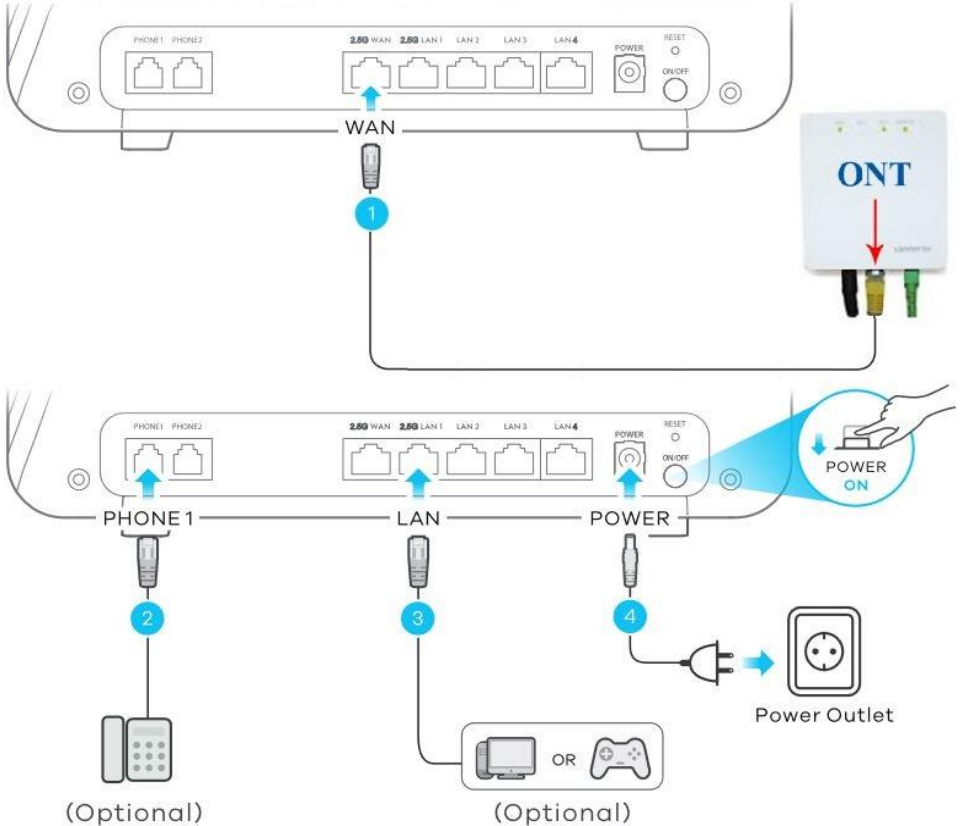



**Zyxel EX5601-T0**

**Quick Start Guide**

# Cabling Setup



 INTERNET	<b>Green On</b> - Internet is ready. <b>---- Off</b> - Internet is not ready.
 POWER	<b>Green On</b> - Power is on. The Zyxel Device is ready for use. <b>Blinking</b> - Starting up. <b>Red On</b> - Malfunctioning. <b>Blinking</b> - Upgrading firmware.

1. Use an Ethernet cable to connect the **2.5G WAN** port to the **ONT**
2. Connect a phone to the phone port using the phone cable (optional)
3. Connect a computer to the LAN port using an Ethernet cable (optional)
4. Connect the power cable to the Zyxel Device and press the power button on

# WiFi Connection

## Using SSID

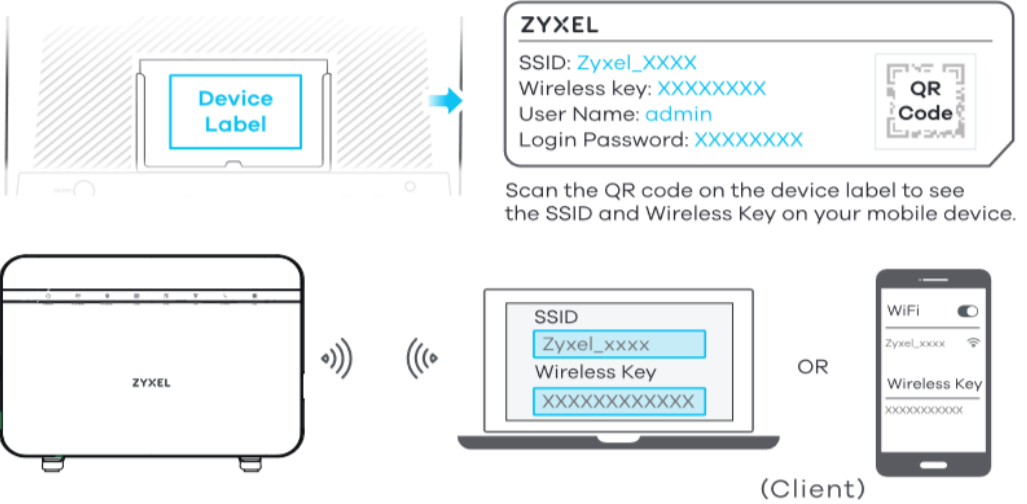

The SSID and Wireless Key are on the device label.  
On your device, find this SSID and enter the Wireless Key to connect.

## Using WPS

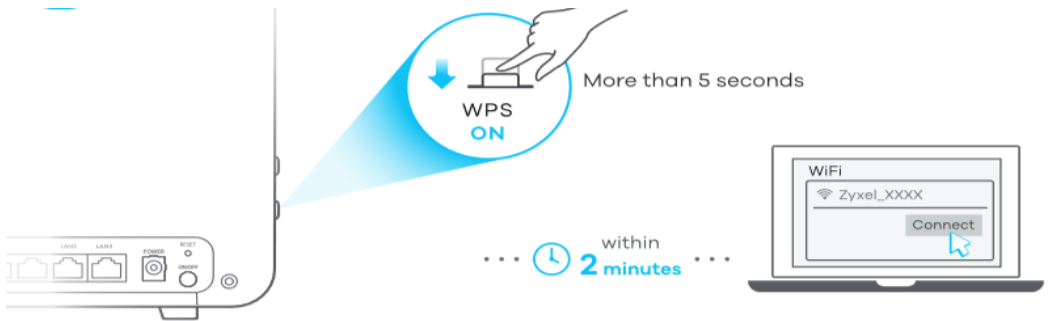

	<b>Amber Blinking</b> - The ZyXel Device is connecting to 2.4 GHz WiFi client via WPS. <b>Green On</b> - 2.4 GHz WiFi is ready.
	<b>Amber Blinking</b> - The ZyXel Device is connecting to 5 GHz WiFi client via WPS. <b>Green On</b> - 5 GHz WiFi is ready.

Press the WPS button until the 2.4G and 5G LED's light up amber

Press the WPS button on the client device within 2 minutes

# Desktop Placement

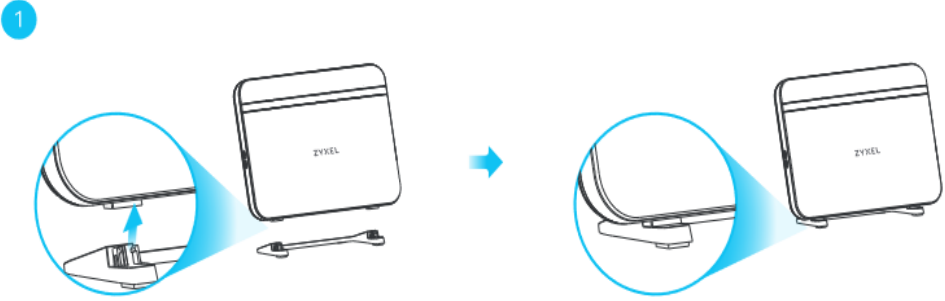

# Wall Mounting

